



American Concrete Industries

TYPE "F" CATCH BASIN SPEC SHEET

CATALOG SECTION: COMMERCIAL.MANHOLES.TYPEF

LAYOUT NAME: CATALOG VERTICAL

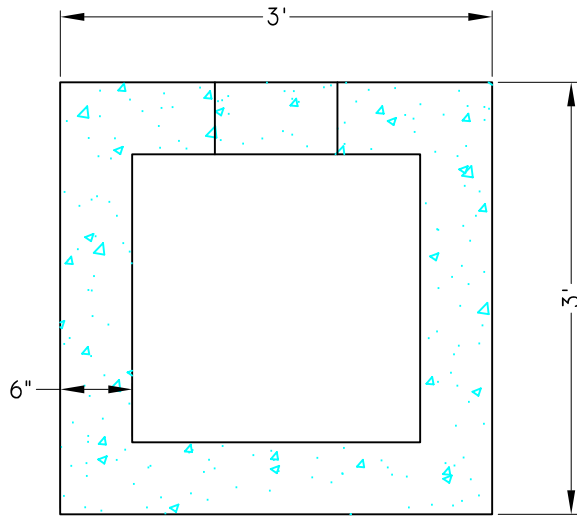

GENERAL SPECIFICATIONS:

- 1) 4000 PSI CONCRETE AT 28 DAYS.
- 2) DESIGNED FOR H-20 WHEEL LOADING.
- 3) CONFORMS TO ASTM C-478 AND M.D.O.T SPECIFICATIONS.
- 4) REINFORCED TO 0.12 IN.SQ./L.F.

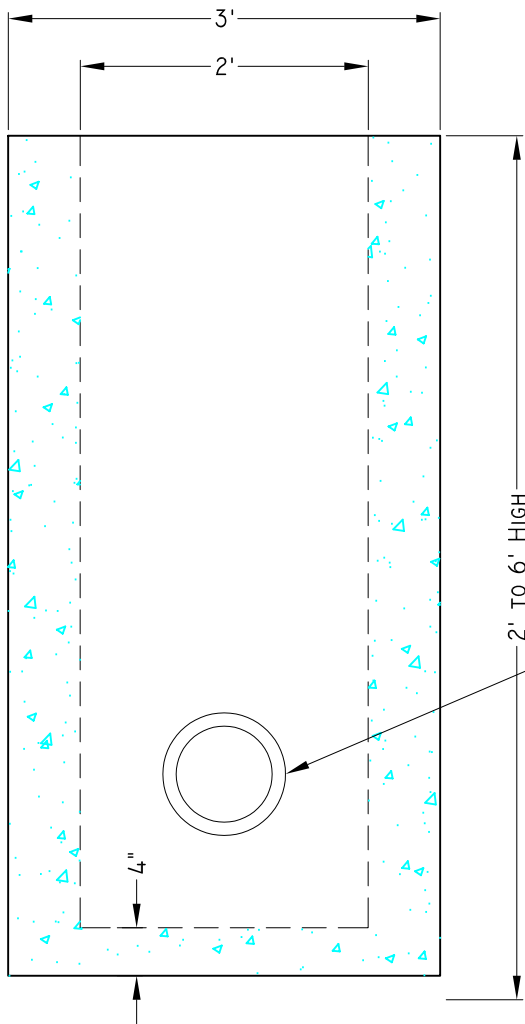

TYPE "F" CATCH BASIN

| APPROX. WEIGHTS (LBS.) | |
|------------------------|-------------|
| BARREL | 725# V.F. |
| FLOOR | 196# |
| GAL/FT | 29.9 GAL/FT |